

Data sheet

Commercial Art.No.: 80.063.4001.1

screw terminal socket FLARE MOVE SF38 24V DC

relais holder frare MOVE , supply voltage 24 VDC, screw clamp terminal, width 6,2 mm type: flare MOVE SF38 24V DC



| | |
|--------------------|---------------|
| Commercial Art.No. | 80.063.4001.1 |
| EAN | 4015573659148 |
| Order Unit | 10 |

certificates / approvals



Technical data

classification

| | |
|------------|----------|
| ECLASS 11 | |
| ECLASS 8.1 | 27371603 |
| ETIM 9.0 | EC001456 |
| ETIM 8.0 | EC001456 |
| ETIM 7.0 | EC001456 |
| ETIM 6.0 | EC001456 |
| ETIM 5.0 | EC001456 |
| ETIM 4.0 | EC001456 |

product compliance

| | |
|------------------------------|-----------|
| ROHS conformity status | compliant |
| REACH-SVHC conformity status | compliant |

Accessories

| Commercial Art.No.: | Article-type description: | Description: |
|---------------------|---------------------------|--------------|
| | | |

Weitergabe sowie Vervielfältigung dieses Dokuments, Verwertung und Mitteilung seines Inhalts sind verboten, soweit nicht ausdrücklich gestattet. Die Reproduktion, Distribution und Utilization of this document as well as the communication of its contents to others without express authorization is prohibited.

A
1
2
3
4
5
6
7
8
9
10
11
12
13
14
15
16
17
18
19
20
M1
M2
M3
L
G
i
11.1
12.1
1.1

00 - PEE 12/92

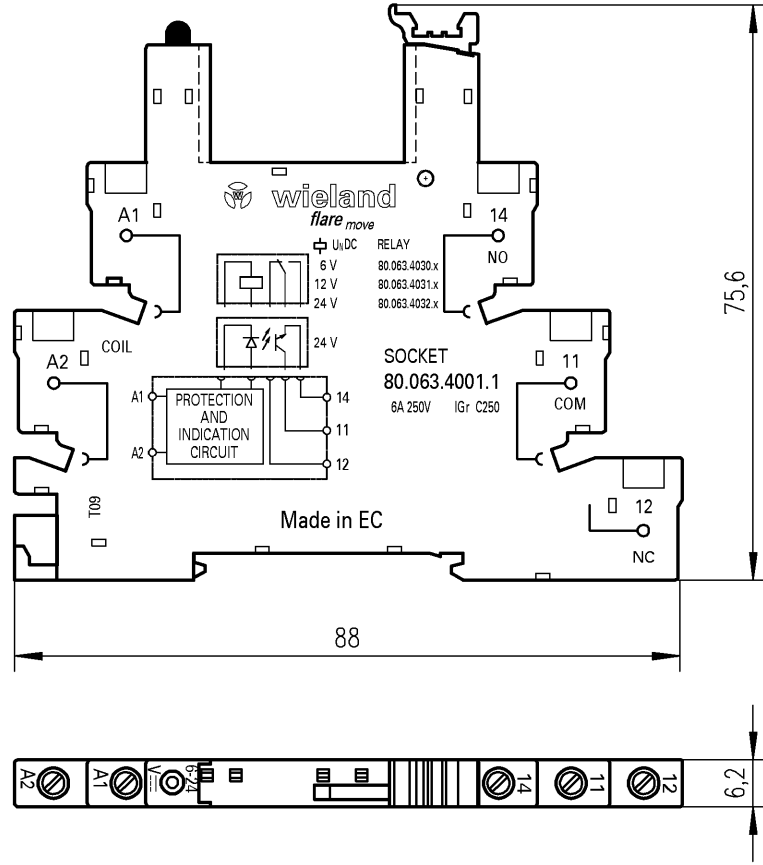

ja/yes Stoffverbots- und Deklarationsliste nach UU-TQM-05/03 ist einzuhalten.
 Conformity with Wieland document UU-TQM-05/03 (list of prohibited / declarable hazardous substances) to be declared!

| | | | | | | | | |
|--------------------------------------------------------|--|-------------------------------------------------------------------------------------------|---------------------------|---------------------------------|-----------------------------------------------------------------------------------|--|------------------|--|
| Freitoleranz nach General tolerance | | CAD-Zeichnung, keine manuellen Änderungen CAD-Drawing, no manual modifications allowed | | | 1. Verwendung: First Use: | | Blatt: Sheet: | |
| Werkstoff/ Material Allgemeintoleranz ISO 2768-m | | 2010 gezeichnet drawn | Tag/ Date 22.11. | Name Viernekäs | Zeichnung Nr./ Drawing No. 80.063.4001.1 01K | | | |
| Maßstab/Scale | | geprüft checked | Normgepr. Stand. check | Maße in mm/Dimensions are in mm | | | | |
| Datei/ File: 019511_1K.DCD | | Ersatz für/ Replacement for: | | | | | | |
| Index Datum/ Blatt Date/ Sheet | | wieland Elektrische Verbindungen | | Type | Benennung/ Title Schraubfassung / SCREW TERM. SOCKET flare move SF38 24V DC | | | |
| Änderung/ Revision | | | | | | | | |

DIG-CAD Druckauftrag CADW2034 Viernekäs 2010-11-23T14:01:45 1.000